

# General Services Administration

## Authorized Federal Supply Schedule Price List Federal Supply Service – Furniture



*For information on this veneer desk  
and matching components  
please contact us.*

DARRAN

Contractor:

# ATD=AMERICAN

We are a Women-Owned Small Business Enterprise

**GSA Contract Holder**  
**GS-28F-0029V**

GOVERNMENT SALES OFFICES  
135 Greenwood Ave  
Wyncote PA 19095-1396  
Phone 888.283.2378 215.576.1003  
Fax 888.737.2378  
Email govsales@atd.com

WASHINGTON DC METRO AREA  
Phone 888.283.7733  
Fax 301.838.0316



Ordering Information page 167

**Additional Items are available - contact us for details**

**Approved  
Navy BPA Vendor**  
Award# N00189-11-A-0017  
East • West • OCONUS



# Rugged Plastic Stacking Chair

Contoured Comfort • Maintenance-Free

Features extra comfort and durability. Contoured one-piece shell of high-impact polypropylene plastic. Exclusive "frame shield", rolled edges and extra front cross-brace guarantees strength. Virtually maintenance-free, easily cleaned with a damp cloth. Chrome-plated legs of 17-gauge, 7/8" tubular steel. Stacking buttons and non-marring floor glides. Overall: 19" W x 19" D x 31" H.

Model	Price
2T-26480	\$26.56

Order in increments of 4 (price is per chair)

Prices do not include shipping charges. Please call for freight quote.

SIN# 711-19 **inStock**

### Colors

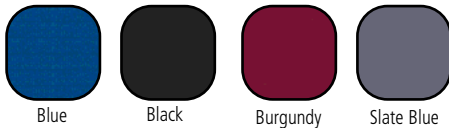

Blue

Black

Burgundy

Slate Blue



2T-26482 Dolly  
Holds 12 chairs.  
**\$92.53**



*frame shield  
protects against  
snags and pinching,  
adds strength and  
support*



Weighs only 8 lbs.  
yet supports  
450 lbs.!



2T-186012 Dolly  
Holds 36 chairs.  
(Not on contract.  
Call for open market pricing.)

### 5 Color Combinations

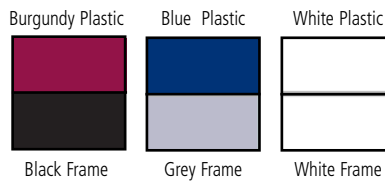

Black Frame

Grey Frame

White Frame



Black Frame

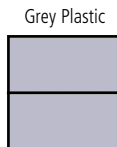

Grey Frame

# Lightweight Plastic Folding Chair

Folds easily . . . stacks 36 high

Combines the strength of a steel folding chair with the benefits of plastic. Contoured comfort! Maintenance free! Use indoors or out! Comfort-contoured seat and back of injection-molded polypropylene. Scratch-resistant and easy to clean. Colors will not fade. Seat has steel frame for added strength.

Sturdy frame of electrically seam-welded 18-gauge steel with double hinges on sides to prevent buckling. V-shaped plugs on rear legs and double-riveted inverted-U cross-braces provide extra strength and stability. Non-marring polypropylene leg glides. Durable powder-coat frame finish. Overall: 19" W x 21" D x 30" H. Seat: 16" W x 17" D.



Model	Style	Price
2T-10020	Folding Chair	\$15.86

Order in increments of 4 (price is per chair)

Prices do not include shipping charges. Please call for freight quote.

SIN# 711-19 **inStock**



# Premium Padded Folding Chairs

**Triple Braced and Double-Hinged for Strength, Double-Contoured for Comfort. Supports up to 450 lbs.**

Sturdy, comfortable chairs upholstered in your choice of durable vinyl or long-wearing stain-resistant fabric. 1" thick foam padded seats. Fully upholstered, full-size backs with double contour for maximum comfort. Heavy-duty 18-gauge steel frames with double hinges on sides to prevent buckling. V-shaped plugs on rear legs and double-riveted inverted-U triple cross-braces for extra strength and stability. Seats and backs of 20-gauge steel with fully curled safety edges. Non-marring polypropylene leg glides. Size: 18" W x 20" D x 29" H; Seat: 16" W x 16" D.

	Model	Upholstery	Price
A.	2T-12540	Fabric	\$19.72
-	2T-12542	Vinyl	18.65

Order in increments of 4 (price is per chair)

Prices do not include shipping charges. Please call for freight quote.



A

### Vinyl/Frame Combinations

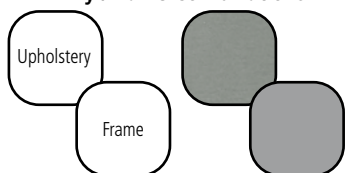

Warm Grey Vinyl / Grey Frame

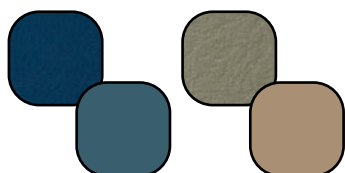

Dark Midnight Blue Vinyl / Char-Blue Frame / French Beige Vinyl / Beige Frame

### Fabric/Frame Combinations

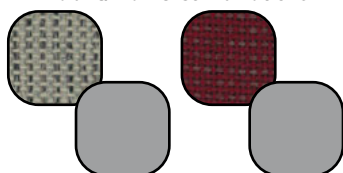

Greystone Fabric / Grey Frame / Majestic Cabernet Fabric / Grey Frame

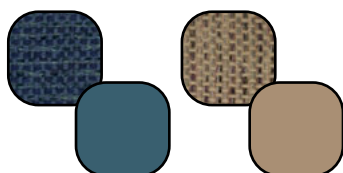

Imperial Blue Fabric / Char-Blue Frame / Cafe Beige Fabric / Beige Frame



three double-riveted U-braces



durable double hinges and rear leg stability plugs

# Premium All-Steel Folding Chairs

**Double-Contoured for Comfort, Double-Hinged for Strength**

- Full-size backs with double contour for maximum comfort
- Heavy-duty 18-gauge steel frames with double hinges on each side to prevent buckling
- Seats and backs of 20-gauge steel with fully curled safety edges
- Non-marring color-coordinated polypropylene leg glides
- V-shaped plugs on rear legs for stability
- Double-riveted inverted-U cross-braces for extra strength
- Overall: 18" W x 20" D x 29" H  
Seat: 16" W x 16" D
- Supports up to 450 lbs.

	Model	Leg Brace	Price
B.	2T-12588	Double	\$13.96
C.	2T-12572	Triple	14.47

Order in increments of 4 (price is per chair)

Prices do not include shipping charges. Please call for freight quote.



C

B

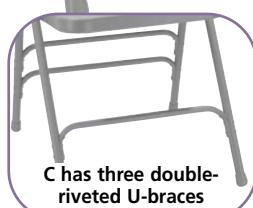

C has three double-riveted U-braces



durable double hinges and rear leg stability plugs



double-riveted U-braces for strength

### Frame Finishes

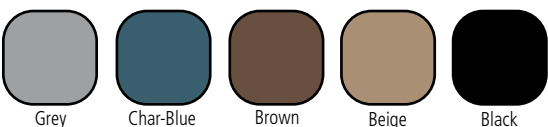

SIN# 711-19



# Fan-Back Folding Chairs

Ventilated Back for Comfort, Triple Braced and Double Hinged for Strength

Supports up to 450 lbs.

Available in your choice of two seat styles



Blue plastic seat/back, Grey frame

### Contoured Polypropylene Seat:

- Scratch-resistant, easy to clean
- Colors won't fade
- Non-marring leg glides match seat/back color



Patterned Classic Burgundy fabric, Burgundy back, Grey frame

### Padded Fabric Seat:

- 1 1/2" thick foam padding
- Upholstered in stain-resistant fabric
- Non-marring leg glides match frame finish



Black plastic seat/back, Black frame



Rose plastic seat/back, Bronze frame



Patterend Prussian Blue fabric, Black back and frame



Cafe Beige fabric, Beige back and frame

- Extra-high ventilated radius polypropylene backrest for added comfort and breathability during long-term use
- Steel-framed seat for extra strength
- Double hinges on sides prevent buckling
- V-shaped plugs on rear legs and double-riveted inverted-U triple cross-braces for extra strength and stability
- Heavy-duty 18-gauge steel frame
- Hand-grip back for easy handling
- Seat: 15" W x 16" D



**12560 Dolly** Holds 84 chairs. (Not on contract. Call for open market pricing.)



**12552 Dolly** Holds 26 chairs. (Not on contract. Call for open market pricing.)

SIN# 711-19

Model	Seat	WxDxH	Price
2T-12550	Polypropylene	19"x21"x35"	\$19.54
2T-12546	Padded Fabric	19"x20"x34"	24.75

Order in increments of 4 (price is per chair)

Prices do not include shipping charges. Please call for freight quote.



# Premium Padded Folding Chairs

## Double-Hinged for Strength, Double-Contoured for Comfort

Sturdy, comfortable chairs. Upholstered in your choice of durable vinyl or long-wearing stain-resistant fabric. 1 1/4" thick foam-padded seats. Fully upholstered, full-size backs with double contour for maximum comfort. Heavy-duty 18-gauge steel frames with double hinges on sides to prevent buckling. V-shaped plugs on rear legs and double-ripped inverted-U cross-braces for extra strength and stability. Seats and backs of 20-gauge steel with fully curled safety edges. Non-marring polypropylene leg glides match frame color. Size: 18" W x 20" D x 29" H; Seat: 16" W x 16" D.

Supports up to 450 lbs.



Stacking / Folding Tables & Chairs

### Vinyl/Frame Combinations

Upholstery

Frame

Warm Grey Vinyl / Grey Frame

Honey Brown Vinyl / Beige Frame

Caviar Black Vinyl / Black Frame

Dark Midnight Blue Vinyl / Char-Blue Frame

French Beige Vinyl / Beige Frame

### Fabric/Frame Combinations

Greystone Fabric / Grey Frame

Majestic Cabernet Fabric / Grey Frame

Russet Walnut Fabric / Brown Frame

Imperial Blue Fabric / Grey Frame

Imperial Blue Fabric / Char-Blue Frame

Cafe Beige Fabric / Beige Frame



12560 Hanging Chair Truck – Holds 84 chairs with 1" thick seat, or 60 chairs with 2" thick box seat. Dark brown finish. 67" W x 34" D x 75" H (fits thru 80" doorway). Shipped ready to assemble. (Not on contract. Call for open market pricing.)



Model	Upholstery	Price
A. 2T-12584	Fabric	\$18.89
B. 2T-12586	Vinyl	18.28

Order in increments of 4 (price is per chair)

Prices do not include shipping charges. Please call for freight quote.

SIN# 711-19

iNstock





ANSI/BIFMA Approved



optional front-to-back filing hangrail kit

### Heavy-Duty Lateral Files

- Premium files feature a double-wall base and extra heavy-duty drawer slides to meet the most demanding filing requirements
- Heavy-duty 3-piece precision steel ball-bearing slide suspension
- Reinforced double-wall base construction
- Core-removable lock allows optional one-key convenience for multiple files
- Adjustable leveling glides
- Full-width designer drawer pulls
- Anti-tip safety mechanism prohibits more than one drawer opening at a time
- Dual lock bars secure both ends of drawers
- Counterweights included
- Hangrails included for side-to-side filing
- Magnetic label holder for each drawer
- 5-drawer units include posting shelf and rollout binder shelf
- All files 18<sup>5</sup>/<sub>8</sub>" deep
- 30% recycled material

#### Finishes



Deluxe					
Drawers	Ht.	36" Wide		42" Wide	
		Model	Price	Model	Price
2	28"	9V-190050	\$190.64	9V-190053	\$220.07
4	53"	9V-190051	311.96	9V-190054	359.70
5	68"	9V-190052	422.81	9V-190055	476.77

Option: 9V-190012 Front-to-Back Filing Hangrail Kit (accommodates 2 drawers on 30" and 36" files, 1 drawer on 42" files)...7.52 per kit

Premium							
Drawers	Ht.	30" Wide		36" Wide		42" Wide	
		Model	Price	Model	Price	Model	Price
2	28"	9V-190000	\$195.55	9V-190004	\$210.92	9V-190008	\$238.38
3	41"	9V-190001	259.31	9V-190005	283.84	9V-190009	324.71
4	53"	9V-190002	324.38	9V-190006	340.08	9V-190010	389.46
5	68"	9V-190003	440.47	9V-190007	475.13	9V-190011	561.13

Option: 9V-190012 Front-to-Back Filing Hangrail Kit (accommodates 2 drawers on 30" and 36" files, 1 drawer on 42" files)...7.52 per kit

Prices on this page do not include shipping charges. Please call for freight quote.

### Heavy-Duty Vertical File Cabinets

#### 25" and 26.5" deep files...all with a Premium Suspension

- Heavy-duty reinforced steel construction
- Double steel-wall drawer fronts on 26.5" files
- Precision steel ball-bearing slide suspension provides smooth, quiet drawer operation
- 3-piece telescoping slides allow maximum drawer extension for easy access to files
- Core-removable lock allows optional one-key convenience for multiple files
- High-side drawers hold hanging file folders, no hangrails needed
- Aluminum drawer pulls and label holders
- Adjustable metal follower blocks keep drawer contents in place
- Galvanized steel drawer body protects against rust
- 30% recycled material

ANSI/BIFMA Approved



#### Finishes



Style	Ht.	25" Deep		26.5" Deep	
		Model	Price	Model	Price
2 Drawer Letter	29"	9V-190030	\$84.04	9V-190034	\$99.74
2 Drawer Legal	29"	9V-190031	105.62	9V-190035	118.70
4 Drawer Letter	52"	9V-190032	117.07	9V-190036	137.67
4 Drawer Legal	52"	9V-190033	141.59	9V-190037	158.27
5 Drawer Letter	62"	—	—	9V-190038	202.74
5 Drawer Legal	62"	—	—	9V-190039	226.94

Letter-size files are 15" wide; legal, 18"

SIN# 711-3



# Quality Lateral Files



- Heavy-duty steel construction
- 3-piece, precision steel ball-bearing slide suspension
- Core removable lock allows optional one-key convenience for multiple files
- Monochromatic drawer pulls
- Interlock system prohibits the extension of more than one drawer at a time
- Counterweights included
- Hang rails included for side-to-side filing
- Dual lock bars secure both ends of drawers
- Adjustable leveling glides
- Durable baked enamel finish
- All files 18<sup>5</sup>/<sub>8</sub>" deep



optional front-to-back filing hangrail kit



ANSI/BIFMA Approved

### Finishes



Black Putty Light Grey

		36" Wide		42" Wide	
Drawers	Ht.	Model	Price	Model	Price
2	28"	9V-190022	\$188.03	9V-190024	\$217.13
4	53"	9V-190023	307.71	9V-190025	354.80

Option: 9V-190012 Front-to-Back Filing Hangrail Kit (accommodates 2 drawers on 30" and 36" files, 1 drawer on 42" files)...7.52 per kit



## File Cabinet Caddies

Move any file cabinet safely and easily



A

Sturdy Steel Construction in a Black Finish



B

- A. Lateral File Caddy – Adjusts to fit cabinets 30-42"-wide by 18"-24"-deep. Heavy-duty casters (2 locking).
- B. Vertical File Caddy – Adjusts to fit 18-26<sup>1</sup>/<sub>2</sub>" deep letter or legal-size file cabinets. Dual-wheel carpet casters.

	Model	For Files	Price
A.	9V-190017	Lateral	\$68.02
B.	9V-190016	Vertical	14.06

## 3-in-1 Lateral-Bookcase Combo

Combines file, bookcase and printer stand in one space-saving design

ANSI/BIFMA Approved

- 1 fixed shelf, 1 adjustable shelf and 2 file drawers
- 3-part telescoping, precision steel ball-bearing slide suspension
- Includes core removable lock
- Both shelves allow binder storage
- Knockouts in back panel for cable management
- Overall: 60" H x 36" W x 18<sup>5</sup>/<sub>8</sub>" D

Colors: specify black or putty



Model	Price
9V-190049	\$302.80

Prices on this page do not include shipping charges. Please call for freight quote.

SIN# 711-3



# Boltless Steel Shelving



All styles assemble vertically or horizontally to fit almost any space. Quick assembly with a rubber mallet.

## Light-Duty Series

- Total capacity of 900 lbs. (evenly distributed weight)
- Sturdy steel posts and beams
- Rugged particleboard shelves
- Baked-on black enamel finish

## Medium-Duty Series

- Total capacity up to 2400 lbs. (evenly distributed weight)
- Patented design
- Heavy-gauge steel posts and beams
- Smooth outer posts with hidden shelf attachments for a clean look
- Rust-resistant
- Rugged particleboard shelves
- Galvanized finish

## Heavy-Duty Series

- Total capacity of 2200 lbs. (evenly distributed weight)
- Patented design
- Heavy-gauge steel posts and beams
- Smooth outer posts with hidden shelf attachments for a clean look
- Rust-resistant
- Rugged particleboard shelves
- Light grey baked-on enamel finish



Light-Duty Series



Heavy-Duty Series



Easy assembly



Use vertically or horizontally



Medium-Duty Series

Light-Duty Series					
Model	WxDxH	Shelves	Capacity	Price	
9V-190040	36"x16"x60"	4	900 lbs.	\$32.05	
9V-190041	36"x16"x72"	5	900 lbs.	40.55	
Medium-Duty Series					
Model	WxDxH	Shelves	Capacity	Price	
9V-190042	30"x16"x60"	4	2400 lbs.	\$40.55	
9V-190043	36"x18"x72"	5	2400 lbs.	50.69	
9V-190044	48"x18"x72"	5	1700 lbs.	76.85	
Heavy-Duty Series					
Model	WxDxH	Shelves	Capacity	Price	
9V-190047	48"x24"x72"	5	2200 lbs.	\$90.91	

Prices on this page do not include shipping charges. Please call for freight quote.

# Riveted Steel Boltless Shelving

- Total capacity of 3800 lbs. (evenly distributed weight)
- Heavy-duty riveted steel construction
- Rugged particleboard shelves
- Quick assembly with a rubber mallet
- Assembles vertically or horizontally to fit almost any space
- Sleek styling with riveted shelf attachments
- Smooth rust-resistant black powder-coat finish



Use vertically or horizontally



SIN# 71-310

Model	WxDxH	Shelves	Capacity	Price
9V-190048	48"x18"x72"	5	3800 lbs.	\$86.00
9V-190060	36"x18"x72"	5	3800 lbs.	76.19
9V-190061	36"x16"x60"	5	3800 lbs.	72.59





# Easy-Access Roll-Out Files



## Constructed for Extensive Commercial Use

- All drawers above the bottom have receding fronts and roll-out shelves for quick, convenient access
- Bottom drawers have fixed fronts
- Hang rails for side-to-side filing of letter, legal and A4 size documents
- Perfect for end tab folders
- 5-drawer models have roll-out binder storage in top 2 drawers
- Heavy-duty steel ball-bearing slide drawer suspension
- Anti-tip safety mechanism prevents more than one drawer opening at a time
- Dual-lock bars secure both ends of drawers
- Core-removable lock allows multiple cabinets to be keyed alike
- Magnetic label holder for each drawer
- Full-width designer drawer pulls
- Reinforced base construction
- 4 adjustable leveling glides



Ordering Information

Model	Style	WxDxH	Price
9V-412520	2-Drawer Lateral File	36"x19"x28"	\$222.03
9V-412521	3-Drawer Lateral File	36"x19"x41"	300.84
9V-412522	4-Drawer Lateral File	36"x19"x53"	374.42
9V-412523	5-Drawer Lateral File	36"x19"x69"	469.25

Prices for these items do not include shipping charges. Call for freight quote.

### Finishes

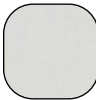

Light Grey



Black



Putty



Ships Assembled

A Women-Owned Small Business

# ATD=AMERICAN

Your Source of Experience for GSA Approved Furnishings

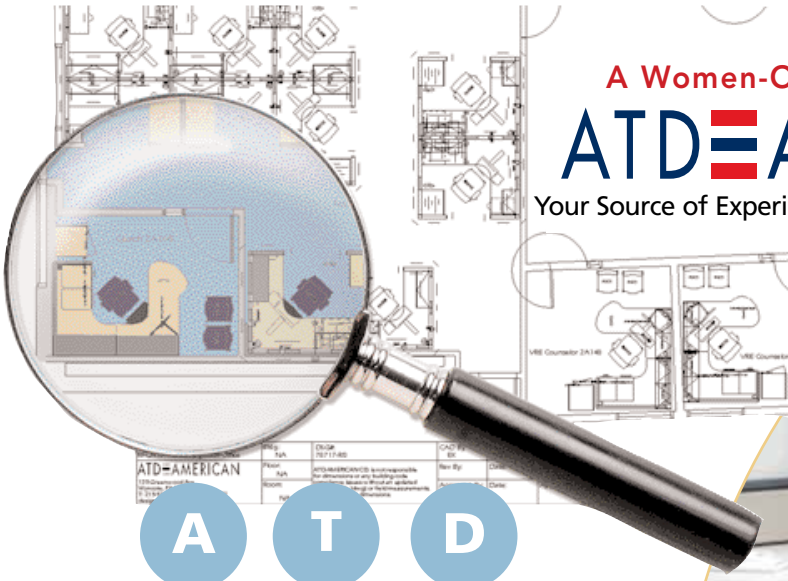

ATD

## Attention To Detail

Our "Attention To Detail" in everything we do is what takes the stress out of buying furniture for you!

1

### Peace of Mind

- Proven Track Record
- Serving the special needs of the Federal Government since 1931
- Quality Brand Name Products
- Hassle-Free Ordering

2

### Customer Focus

- Rapid Response and Expert Customer Service
- In-Stock products ship within 5 days
- Free Space Planning & Design
- Free swatches & finish samples
- On-Site Consultation
- Nationwide Installation available for a Turn-Key Furniture Solution
- Can meet set-aside requirements from an array of Socio-economic defined dealer partners
- Teaming Capabilities with the following: 8(a) firms, Veteran-owned businesses, SDVOB's, SBA-certified HUBZone Firms, and BPA's

3

### Product Knowledge

- Expert Staff with an average of 15 years experience
- Wide selection of environmentally friendly products
- Project Management Team
- Product Sourcing: Don't see what you want? Call ATD. We'll find it for you!

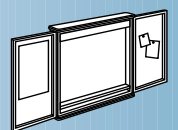
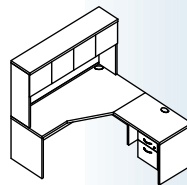
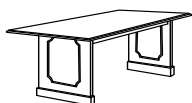

# ATDesign

SPACE PLANNING

## FREE Space Planning

### Your Needs...Your Space...Your Style...Your Budget

From individual spaces to entire buildings, tell us what you need and we'll make it easy for you!

Our space planning experts use state-of-the-art software to create customized offices, workstations, conference, training and reception areas that meet your needs and your budget. We're dedicated to paying attention to detail and responding to your every request.

Tell us about the style and type of furniture you prefer, plus any special requirements. We'll send you a complete proposal, including CAD drawings, recommended furniture and accessories and free color samples.

We can even arrange to have your new furniture installed by our team of professional installers.

**What you need, when you need it - on GSA contract or open market.  
Call 888-283-2378 or e-mail designs@atd.com**

## Professional Installation and Project Management Services Available!

- Warehousing
- Removal of Existing Furniture
- Consolidation
- Inside Delivery
- Assembly and Set-Up
- Trash Removal
- Warranty Service

## Representatives Nationwide

**GOVERNMENT SALES OFFICES**  
135 Greenwood Ave  
Wyncote PA 19095-1396  
Phone 888.283.2378 215.576.1003  
Fax 888.737.2378  
Email [govsales@atd.com](mailto:govsales@atd.com)

**WASHINGTON DC METRO AREA**  
Phone 301.838.0323  
Fax 301.838.0316

**Contractor: ATD-AMERICAN CO.**

**Contract Numbers:** GS-28F-0014Y  
GS-28F-0030P  
GS-28F-0029V

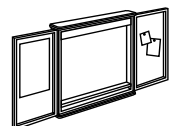
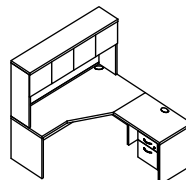
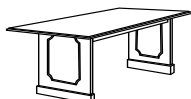

Call for your **FREE** copy of our new 2012 GSA catalog or e-mail us at: [fedgov@atd.com](mailto:fedgov@atd.com)

# “Going Green” is not just a slogan. It’s the way we run our business.

We at ATD-AMERICAN believe that a healthy environment is essential for our company, for our planet, and especially for those who use our products.

We work every day to find and implement ways to protect and sustain our environment and its resources. Here are just a few of our solutions:

- **Sustainable Use of Resources** - We select products that are designed for durability and optimal reusability or recyclability. We also make every effort to ship products from the source closest to a customer’s location in order to save fuel.
- **Air Quality and Emissions** - Both children and adults spend about 85% of their time indoors, where the air is two to five times more polluted than outdoor air. As a result, they face long-term health risks due to indoor air pollution. Studies show that using “green” materials improves indoor air quality, boosts performance and decreases illness and absenteeism. You’ll breathe easy when you select school and office furniture with Greenguard® or Indoor Advantage™ certification. These products have been tested and certified compliant with stringent emission requirements in an effort to improve indoor air quality. This certification is broadly recognized and accepted by a number of “green” building programs, including the U.S. Green Building Council (USGBC) LEED® program.
- **Waste Reduction and Recycling** - As a company, we have made a commitment to conduct our own business in a sustainable manner and make every effort to recycle, re-use and reduce waste. We have implemented an in-house recycling program for paper, plastic, glass and aluminum used in office processes. The cardboard and packaging of most products chosen by ATD is recycled and/or is made from recycled materials. We also require ATD installers to dispose of or remove trash from sites to appropriate recycling locations.
- **“Green” Partners** - We seek out business partners who share our commitment to the environment. Their efforts include implementing eco-friendly manufacturing processes, using recycled or renewable raw materials, and producing green-certified products.

By implementing these solutions, ATD aims to reduce our impact on and promote responsibility for the environment across all levels. We also promise to continually improve our business practices in order to protect and sustain the environment and its resources for the people of today and for generations to come. We welcome your comments and suggestions, and we encourage you to let us know how your offices and schools are “Going Green”.



## ATD AMERICAN

135 Greenwood Ave • Wyncote, PA 19095-1396  
Call Toll-Free: 888.283.6733 **FED GOV:** 888.283.2378  
Visit us online at [www.atd.com](http://www.atd.com)

**Contract #'s**  
**GS-28F-0030P**  
**GS-28F-0029V**

**GSA Codes:**

**Federal ID #231921196**

**Cage Code: 5A439**

**DUNS#001992338**

**CCR Registration: Yes**

**ORCA Registered: Yes**

**Federal Certifications:**

Women-Owned Small Business  
 Furniture Contract

**2008 Government compliance report card score: Exceptional**  
 Government Commercial Credit Card:  
 Accepted

**NAICS CODES**

- 321999** Wood Product Manufacturing
- 332999** Fabricated Metal Product Manufacturing
- 337127** Institutional Furniture Manufacturing
- 337211** Wood Office Furniture Manufacturing
- 337214** Office Furniture (except Wood) Manufacturing
- 337215** Showcase, Partition, Shelving, and Locker Manufacturing
- 423210** Furniture Merchant Wholesaler
- 541410** Interior Design Services

**General Services Administration**  
**Authorized Federal Supply Service Contract Holder**

ATD-AMERICAN is a Woman-Owned Small Business and a nationwide distributor representing Government, Education and Commercial sales.

We represent many quality furniture manufacturers all under one GSA contract. In an effort to fulfill all of your unique requirements, we provide an even deeper selection of products by utilizing many teaming agreements with a wide variety of furniture manufacturers.

Our GSA Furniture **Contract #GS-28F-0030P** and **#GS-28F-0029V** provide turnkey solutions for agencies who require a wide variety of products and services, and the ability to manage their entire project with one purchase order. We currently hold several BPA's with Federal Government agencies and Military bases.

ATDesign specialists offer Free Design and Space Planning that utilizes state-of-the-art software to provide customized drawings for individual workstations, complete offices or entire buildings.

Installation services are available nationwide to install new office furnishings, modular and systems configurations, filing and storage systems, and tables and seating for conference rooms, banquet rooms, lounges and auditoriums.

**A Women-Owned Small Business**

*Your Source of Experience for the Total Office Environment Since 1931*

**CALL 888.283.2378** [www.atd.com](http://www.atd.com)



**Contact info:**

*Regional Sales Manager:* James Fort  
 12201 Milestone Manor Lane  
 Germantown MD 20876  
 301.972.2926  
 jfort@atd.com

**Corporate Office:**  
 135 Greenwood Ave.  
 Wyncote, PA 19095

# Value PROPOSITION

## 1 Needs Determination

Whether the project involves one room or an entire building, every project begins with our ATDesign survey. We ask questions about the current work environment, multiple use needs for the space and what currently works and what does not work. We ask how users interact in the space and what items (computers, reference material, files supplies etc) need to be conveniently located for everyone to perform at their best. The answers to those questions help us zero in on your requirements and allow us to find a solution that is the very best fit to your particular needs and budget.

## 2 Product Selection from 70+ Manufacturers

Our GSA contract allows Government agencies to issue one consolidated purchase order using ATD's extensive list of over 70 Manufacturers. We offer a wide variety of products that will fit any budget. Government agencies can outfit an entire office from one catalog, which will save considerable time and cost.

## 3 Low, Competitive Pricing

Pricing, especially in this economy, is a very important issue. ATD has historically sold to Government Agencies through the bid process. Since 1931 we have been successful in this very competitive arena even when our competitors are manufacturers.

## 4 Nationwide GSA Sales Professionals

Our GSA sales specialists take pride in providing fast, professional service and they understand the unique needs of government agencies. They are available to visit your facility to provide needs determination, measure office space and provide personalized service. All of our representatives have extensive experience selling office furniture to government agencies.

*We would like to present the following information to introduce you to ATD-AMERICAN CO, the ATDesign Team and ATD's GSA furniture contract.*

For price, convenience, selection, product knowledge and design, ATD-AMERICAN CO is your best value supplier for contract office furniture and equipment. We have found the following services set us apart from other suppliers and demonstrate that we can offer your organization a unique solution for all of your furniture needs.

## 5 Free Design Services

Another important distinction ATD offers over our competitors is that we never charge for Design Services. Many clients have taken advantage of this valuable service. We measure your space and offer our suggestion for the best possible solution that will fit your budget. We provide professional 2 & 3 dimensional renderings of the office space which are in full compliance with local codes. We supply sample swatches as required.

### The following is a partial list of the commodities we offer under GSA contract:

- Modular Furniture
- Computer Support Furniture
- Cafeteria & Breakroom Furnishings
- File Cabinets (Vertical, Lateral and High Density)
- Training Tables
- Conference Room Tables, Chairs, Boards and Lecterns
- Lounge Furniture
- Traditional and Contemporary Office Seating
- Ergonomic Workspace Solutions
- Panel Systems
- Custom Matted and Framed Artwork
- Sound Lecterns
- Mailroom Furniture
- LAN Furniture
- Folding Chairs & Tables
- Marker boards & Bulletin Boards

## 6 Green Initiatives

At ATD, we are concerned about the environment. We strive to conduct our business in a sustainable manner and make every effort to recycle and reduce waste. We are dedicated to providing our customers with products that preserve our precious natural resources and positively contribute to a healthy work and world environment. We offer a wide variety of "GREENGUARD" indoor air quality Certified products. When requested, we will provide post consumer recycled steel products. Recycled fabrics can also be provided in a number of textures and colors. We strive to provide our customers with high quality products that minimize any impact on the environment.

## 7 Exceptional Service

ATD-AMERICAN Company prides itself on our proven ability to deliver outstanding services as well as on-time delivery. The GSA has rated ATD "Exceptional" for our service. We actively work to prevent the occurrence of problems. But, when dealing with furniture, some problems are inevitable. If anything goes wrong, we fix it. Sometimes, you can only appreciate how good we are as a vendor by having a problem and seeing how we respond. You will learn that we stand behind our products and we keep our customers satisfied. We will provide reference contact names and phone numbers upon request.

## 8 Project Management

On larger projects, we meet on site with all parties to make sure that the scope of work is agreed upon and well understood. We follow-up on every aspect of the order to make sure that deadlines are met and project goals are achieved. We will meet with you after a project is completed to make sure that you are completely satisfied and all aspects of the order meet with your expectations.

## 9 White Glove Service

We can arrange to be on-site to meet delivery trucks, unload, install, remove cartons and thoroughly clean the site upon completion of each project. This service is available whenever and wherever you need it. It is especially useful for customers who are short staffed or do not have skilled manual labor available. This service often pays for itself in reduced worker compensation claims.

## 10 Guarantees that are the best in the Industry

ATD has been in business since 1931. With us, a 25 year or lifetime warranty means something, because we will be there for you in the future. We are family owned and operated and our reputation has been built upon a bedrock of reliability.

*Thank you for the opportunity to discuss doing business together. We have been in business for over 78 years and you can count on our experience to make sure that your project, big or small, is handled promptly and with professionalism. Please feel free to contact me at any time to discuss the details of this letter.*

*We look forward to building a mutually beneficial relationship between ATD and your organization.*

# GSA Federal Supply Schedules

Partial List of Manufacturers  
ATD-AMERICAN CO., Contractor

Contract #'s

GS-28F-0030P GS-28F-0029V

## ATD-AMERICAN

Furniture  
Thousands of furniture and accessories from over 50 major furniture manufacturers.

## ABCO OFFICE FURNITURE

Modular furniture, training tables, files, conference tables and seating that offer the ultimate flexibility in single or clustered workstations.

## AIS

Monolithic & tile base stacking panel systems (Herman Miller & Steelcase clones) provide unique solutions for the market, delivering a broad range of system configurations, each adaptable and adjustable to the changing office environment.

## ALLSEATING

Ergonomic boardroom, executive, managerial & task seating.

## ANATOME

Keyboards, monitor arms, CPU holders and task lighting products that incorporate superior ergonomic principles.

## BEST RITE

Bulletin / chalk / markerboards, directory boards and communication boards.

## COMPATICO

High Quality, High Value monolithic and tile base systems furniture providing affordable and flexible workspaces.

## DARRAN

Provides high quality casegoods recognized for its broad spectrum of wood desk collections, conference tables and reception furnishings. All items manufactured in the USA. "Built-to-order" specifications welcome.

## DAUPHIN

Contract: GS-28F-1119C  
One of the world's leading seating manufacturers. Products which embody the concept of health and safety in the office. Dauphin has a proven commitment to healthy posture.

## GREAT AMERICAN PICTURE CO.

Fine Art Prints, Canvas and Photography.  
Perfect for any room in your facility

## GREAT OPENINGS

"A" Grade quality metal desking, filing and storage products

## HIGH POINT FURNITURE

Contract: GS-28F-0030P  
Wood casegoods, conference rooms, lounge furniture seating, healthcare for standard and specialty use. Traditional, transitional and contemporary styles in an array of fabric and wood finishes.

## HIRSH INDUSTRIES

Commercial grade vertical and lateral file cabinets, free standing storage shelving units, filing accessories, ready to assemble wood file cabinets, and other related items.

## HON

Supplying a wide range of Storage, filing, desking, systems, seating and tables. World's first office furniture manufacturer to adopt the indoor advantage program, the most stringent air quality certification program.

## INWOOD

Hand-crafted wood desks, credenzas, bookcases, office and conference room suites. Enduring design with hand-selected materials and meticulous craftsmanship.

## JSI

Contract: GS-28F-0046J  
A Division of Jasper Seating providing quality office furniture and seating since 1929. Distinctive line of casegoods including desks, credenza, storage and reception furniture in traditional and contemporary styles.

## KFI

Stacking chairs of all kinds. Ideal for officer and NCO clubs, auditoriums, dining areas and meeting rooms.

## KI

Contract: GS-28F-2002D  
The 6th largest furniture manufacturer in the U.S. KI is a trusted source of office & institutional furniture for government, business, education and healthcare markets.

## MARTIN FURNITURE

Stylish veneer contemporary, traditional and modular casegoods and conference collections.

## MARVEL

An In-depth line of systems and modular furniture.

## NATIONAL PUBLIC SEATING

Stacking chairs and folding chairs. Blow-molded tables.

## OFM

Well-priced executive, managerial, ergonomic and big-and-tall seating. Reception, break-room, conference and training furniture, and stacking chairs. Versatile high-density steel wire storage systems.

## OFS

Contract: GS-29F-0304H  
Grade A wood casegoods, conference room, lounge and seating manufacturer committed to prevention of pollution and enhancement of the environment.

## OSP

Contract: GS-28F-0030P  
Executive, managerial, big-and-tall, lounge and guest seating.

## TAYCO

State-of-the-art panel system furniture, accessories and storage options. Designer training tables, executive, managerial and laminate casegoods.

## THREE H

Contemporary modular laminate desks and reception stations. From the smallest desk to the most sophisticated working environment...custom designed to the inch!

## TRINITY FURNITURE

High Quality traditional and transitional executive wood seating and lounge furniture.

## ZOOM SEATING

Task, management, executive, guest and stacking chairs that deliver the highest level of design while incorporating a wide range of mechanisms, arms and fabric options.



# ATD=AMERICAN

Your Source of Experience

## Scope of Services for Planning and Design

January 2010



### CONTENTS

- Introduction
- Programming
- Architectural Survey
- Space Planning / Standards Development
- Product Application / Furniture Specification
- Interior Design Coordination
- Quotations / Product Documentation
- Manufacturers
- Biographies
- Summary

*Four Generations of Service . . . Since 1931*

135 Greenwood Avenue Wyncote PA 19095-1396 215.576.1000 FAX 215.576.1827 EMAIL [american@atd.com](mailto:american@atd.com) [www.atd.com](http://www.atd.com)

- Introduction

*Do you have a blank slate?*

*Is time and efficiency critical in your design?*

*Do you want to utilize experience of others who have gained from design solutions of similar problems?*

**ATD's Design Services Group is here to help!**



We will review your proposed request for offices, workstations, training and conference rooms, and all other specialty areas. We will even review your present space standards and make recommendations where better efficiencies can be achieved and implement plans aimed at optimizing the utilization of space and increasing individual and organizational efficiency.

Our goal is to provide the highest quality free design services, along with an outstanding assortment of products, at extremely competitive prices, resulting in a distinct and uncompromised value to our customers.

- Consistently execute with excellence.
- Anticipate the next step in everything we do.
- Proactive problem-solver.
- Display a sense of urgency in producing results.
- Willing to go beyond the scope of your request.
- Always focus on the customer

We offer free programming and space planning services. Read on...

- **Programming**

<b>ATD=AMERICAN</b>	
<b>Design Services Group - Design Request Form</b>	
<i>Email this form along with supporting documents to: <a href="mailto:Designs@ATC">Designs@ATC</a></i>	
Project Title: _____	ATC
RFQ #: _____	Sub
Floor / Building: _____	Date
Project Address: _____	Pho
_____	Em:
Pricing: <input type="checkbox"/> GSA <input type="checkbox"/> State <input type="checkbox"/> Commercial <input type="checkbox"/>	
Product Categories: <input type="checkbox"/> Panel Systems: Quantity: _____	
<input type="checkbox"/> Office Casegoods: Quantity: _____	

Our Design Services Group will review your request to ascertain the specific requirements of the project. They will look to identify all special requirements of acoustics, daylight views, ergonomics, the use of SCS / Greenguard certified products, as well as potential future growth or changes.

ATDesign will ask you to verify that the programming information is accurate and that adjacencies and quantities have been captured for workstation and office occupancy.

They will work with the point of contact to determine other requirements such as types and amounts of filing & storage, any specialized equipment needs, conference room amenities, mail room furniture, etc.

- **Architectural Survey**

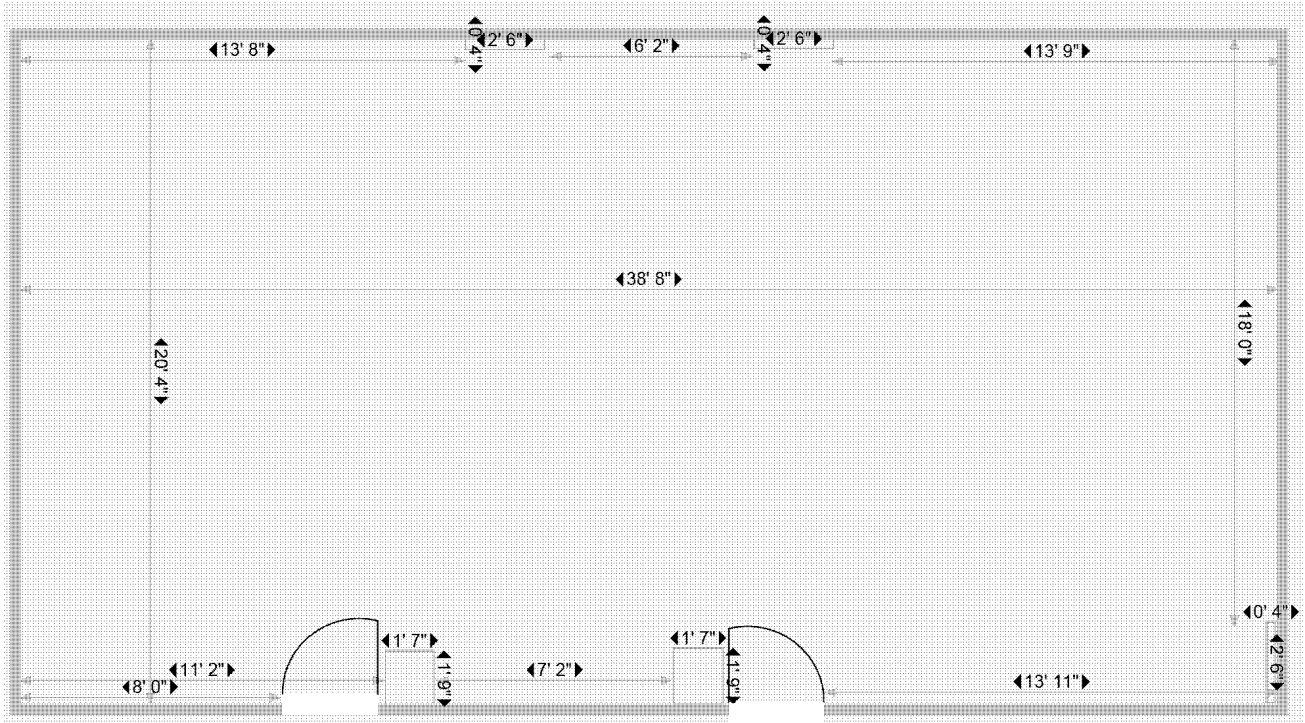

The next stage would be to obtain a floor plan of the conditions at the proposed site. ATDesign will need to understand the layout of base building walls, doors, columns, floors, and ceilings as well as assess the implication of any electrical, fire/safety, HVAC, and plumbing as it relates to the furniture.

A site visit may be necessary to field measure critical areas of the plan to determine the accuracy of the provided CAD plan. This will also aid in identifying any of the building's access concerns when it comes time for installation.

- Space Planning
- Standards Development

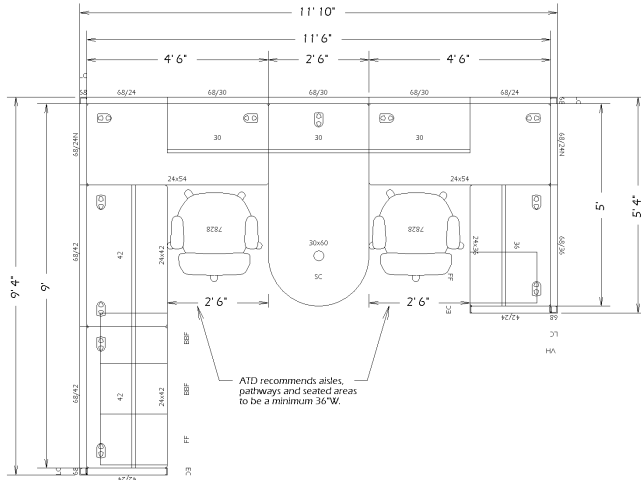

Design#: BM082809HVTANG  
 ATD=AMERICAN  
 135 Greenwood Ave  
 Wyncote, PA 19095

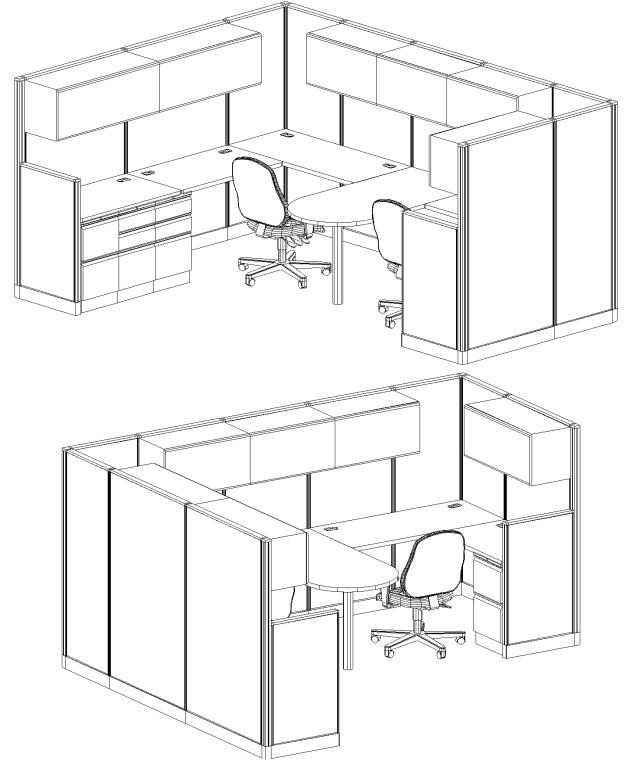

After analyzing the programming requirements to make sure each room, area, or department has been planned according, and ensuring that the space to be planned is true to scale, ATDesign will develop a preliminary layout inserting typical and standards into the established base building plan. We will comply with barrier-free accessibility and means of egress at this point, but it will be the customer's responsibility to verify all local building and occupancy codes.

Following the approval of the preliminary standards and layout, ATD's Design Services Group will refine that layout to be the basis for the Furniture Plan.

- Furniture Specification
- Product Selection

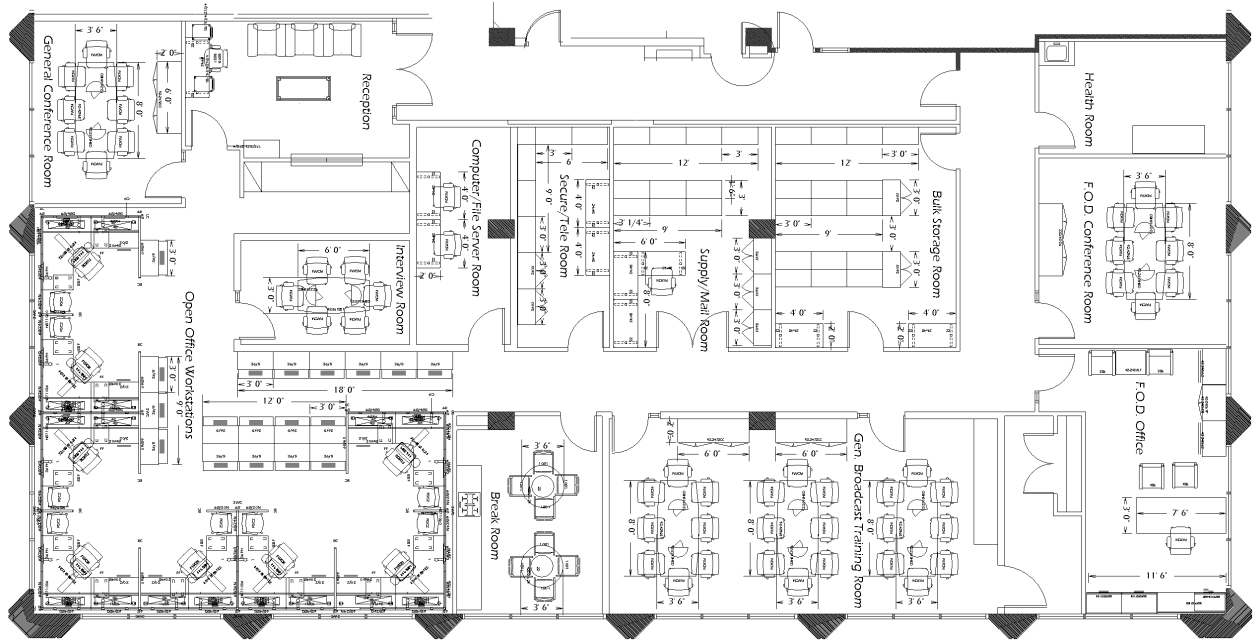

ATDesign will finalize selections for furniture based upon approved space plans and will select manufacturers and products that most suit your needs and functions.

They will prepare CAD plan views and isometric view drawings of typical office and workstation environments to help visually convey the components of each standard.

A preliminary furniture budget will be generated and quotes will be secured and added for delivery and installation of the product based on the approved layout and product selections and features.

Following approval of the final layout, the product selections, and the cost estimates, final specifications will commence.

- **Interior Design Coordination**

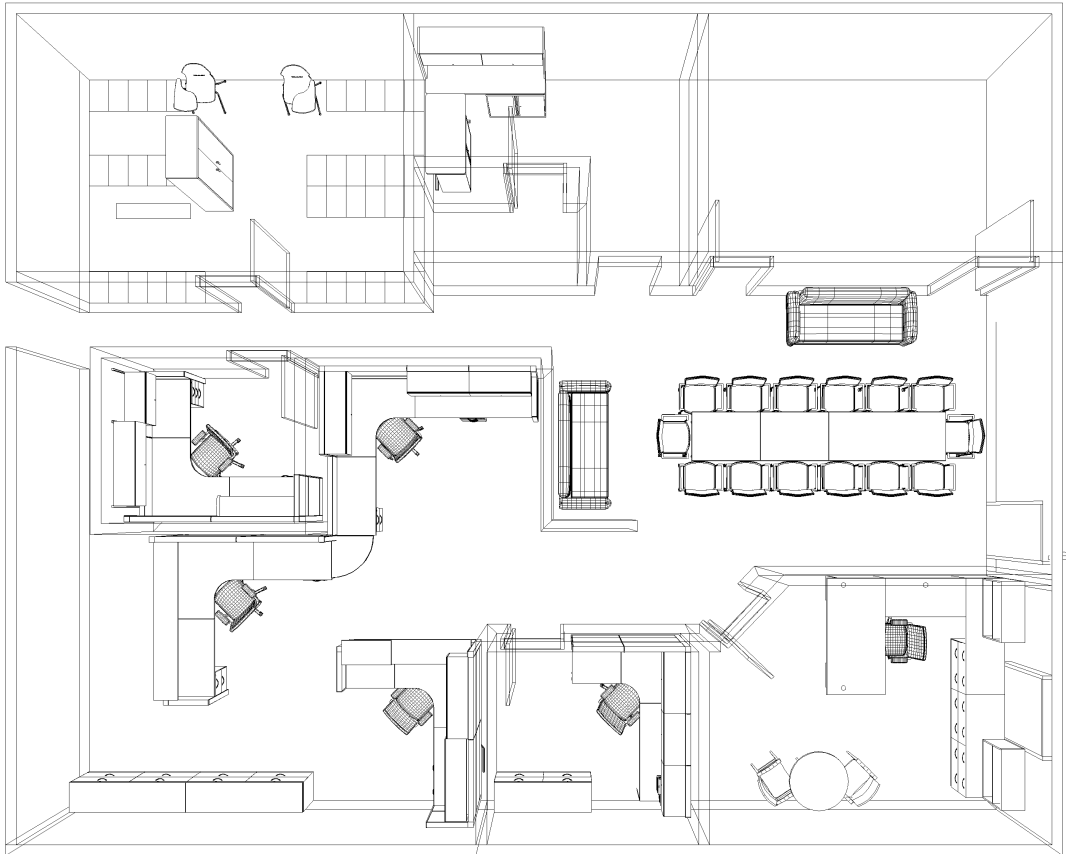

At this time, all fabrics, finishes, and options for the furniture will need to be captured and included on the specifications. The selections for the furniture finishes should be based on the architectural finishes to provide a well thought out, unified space.

Any necessary alterations to the furniture will now take place in situations where the base building architecture dictates. For instance, if a fire cabinet is now positioned on a wall where a filing cabinet was shown to be placed on the floor plan or if a panel height needs to be lowered to access switches or thermostats.

Details such as electrical receptacle quantities and the identification of circuitry will also take place to ensure smooth operation of all equipment and fixtures.

- Quotations
- Product Documentation

Line #		Qty	Part Number	Part Description	Sell Price	Extended
<b>CLIN 0001</b>						
1	2		<b>2111</b>	<b>2110 Series Guest Leg Base Arms</b>		
			Wood Finish Selection	.N FINISH: Mahogany		
			Select Upholstery for 2111	5(4) GRADE: IV Upholstery		
			Upholstery Selection	.DP UPH: Pivot		
			Select Pivot Color	19 COLOR: Tower 19		
2	1		<b>904366</b>	<b>36" Round Veneer Table Top</b>		
			Select Veneer Color	.NNN VEN: Mahogany		
3	1		<b>91214</b>	<b>"X" Base Kit for 36 Top</b>		
			Select Veneer Color	.NN VEN: Mahogany		
4	4		<b>F23B</b>	<b>Black Removable Lock Core Kit</b>		
			Select Key Number	.X101E KEY NUMBER: 101E		

BMD090409A1STAFB rev 9-23-09  
 Contract# **GS-28F-0016P** Page 1 of 49  
 ATD-American Co.

ATDesign's final stage will include providing detailed specifications for all areas to receive furniture. We will help coordinate the furniture procurement process with order entry and on to project management.

Based upon the approved order, ATDesign will prepare furniture installation drawings that will include:

- Conventional freestanding furniture and ancillary product plan.
- Panel System panel plan.
- Panel System electrical plan.
- Panel System component and storage plan.

ATDesign will distribute workstation electrical cut sheets, hardwire information, and installation instructions to the customer's electrician for the furniture systems base building connections.

We can also distribute information to telephone/data vendors if applicable regarding the knock out sizes & locations in the furniture, so a clean installation of voice/data modules can be incorporated and coordinated with all the necessary trades.



- **Manufacturers**

ATD Partial Listing

ABCO*	Great American Picture*	Now
AIS*	Group Lacasse	Oakwood
Allseating*	Great Openings*	Office Star*
American Desk	Hale	OFM*
Amplivox*	High Point*	Paragon
Anatome*	Hirsch*	Penco
Balt	Haskell*	Phoenix
Best-Rite*	HON*	Raynor
Boss	Humanscale	Richardson
BPI	Imperial	Royal
Bretford	Indiana	Safco
Califone	Integra	Sauder
Capel	Inveco	Scholarcraft
Carolina	Inwood*	Schwab
Clarín	Ironwood	Shamrock
CMI	Jolt*	Smith Systems
Community	JSI	System 2/90
Compatico*	KFI*	Rosemount
Concept Seating	KI	Safco
Correll	Kwik-File*	Smith Metal
Customfold	La-z-boy	SP Richards
Darran*	Lesro	Tayco*
Datum*	Luxor	Tennsco*
Dauphin*	Lyon	Texwood
DMI	Magnuson	Three H
Eagle	Martin*	Topstar*
EMU	Marvel*	Trinity*
Encore	Maxon	United Chair
Fire King	Mayline*	Via
Fixtures	Meco	Virco
Georgia	National Public Seating*	Woodcraft
Glaro	Nevers*	Zoom*
Global*	Nova	

\*\*Available through GSA Contract

This is a partial listing and gets updated regularly.

Please ask us about any other lines you do not see listed along with other types of products you are interested in obtaining information about.

Also for our full complement of accessory products, please be sure to view our catalog.

- **Biographies**

**Executive Vice President**

Eric Wischnia, Executive Vice President has over 25 years of expert management and industry experience with ATD. Eric is a visionary whose 'hands-on' leadership style has made ATD the largest and most successful GSA services provider in this market. Eric is responsible for implementing within ATD a strong corporate culture and various strategic programs that involve quality control and value measurements for customers, vendors and employees.

**Design Services Manager**

Karl Espenhorst brought to ATD, his vast product knowledge and a strong background in corporate space planning encompassing 15 years. Karl is ultimately responsible for the success and completion of all design projects worked on by ATD group members. He has strong management and strategic planning skills, and is AutoCAD proficient as well as being a LEED Accredited Professional. Karl acts as the primary liaison between the sales groups and the team driving both the short-term task and long-term goals of the project. Karl has worked in all facets of the contract furniture industry including manufacturing and dealerships.

**Project Management Manager**

Joann Drelling has 15 years experience in project management, customer service and installation programs. Ten years of that has been with ATD. Joann is directly responsible for the daily integration of ATD's vast international network of installation companies. Joann coordinates all receiving, shipping, installations and ATD's inventory management system. She works directly with clients and ATD's team members in the seamless coordination of these programs.

**Technical Coordinator**

Tony Covello is a senior staff designer with ATD for over 8 years, Tony is proficient in 20/20Giza, CAP Worksheet and Oracle. His primary focus is project solutions that involve extensive technical requirement in both the product solution and software integration. Tony is responsible in assisting in the audit process, order entry, reviewing acknowledgements, and preparation of spreadsheets and databases that keeps the group abreast of market trends and factors. Tony has handled complex large scope projects such as Puget Sound Naval Base on a national basis and Maguire and Andrews Air Force bases here on the east coast.

**Planning Specialist**

Elizabeth Kenny is a designer for ATD's Design Service Group (DSG). Elizabeth is a creative and detail oriented designer with a focus on interior planning. Within the group, Elizabeth is responsible for all phases of planning and design, from programming and space planning to finish selection to installation drawings. She has vast experience with furniture and finishes, with a concentration of major lines from systems furniture manufacturers including HON and AIS, along with textile lines from both Momentum and Maharam.

**Product Specification Operator**

Tim McDonough has over 3 years in the design field and 5 years total experience in the contract furniture business with his prior involvement with ATD in the coordination/customer service sector. Tim works with Sales Support, Customer Service, and Project Management to ensure that the project runs smoothly.

- **Summary**



ATD's Design Services Group compliments your company's strategy for business expansion or change by supporting a clear and concise process for design services, with performance, quality, and professional execution.

ATD's Design Services Group will offer a broad range of products that can be value engineered, up or down, to provide flexibility and price scalability that maximizes your investment. We serve both National and International markets and represent over 200 manufacturers.

ATD Design Services Group offers total furniture solutions providing all related services from programming to space planning to install coordination. We are your resource dedicated to servicing and satisfying your needs by paying attention to detail and responding to your every request.

ATD's Design Services Group can respond quickly to the need for change and create layouts, presentation drawings and react promptly to site visits and modifications. Through 2020 Giza, we can keep all furniture plans updated and offer expertise on reconfigurations, space planning, and product selection, including fabric and finish designations.

The end result, as an ATD customer you can be assured you are getting the most appropriate and advanced products for your project, from a company that will be there for you time and time again.

**Why not contact us today.** [Designs@ATD.com](mailto:Designs@ATD.com).

# ORDERING INFORMATION

## Federal Supply Service, Furniture, FSC Group 71

Contract Number: GS-28F-0029V

Expiration Date April 12, 2014

### 1a Special Item Numbers (S.I.N):

71-301 Classroom Solutions  
71-310 Industrial Furniture  
711-3 Filing and Storage  
711-11 Tables and Accessories  
711-19 Stacking and Folding chairs  
711-95 Installation Services

### 1b Lowest Priced Model # for S.I.N:

71-301	NPS-6430H	\$34.75
71-310	HIR-17187	\$32.05
711-3	HIR-13350	\$1.96
711-11	NPS-SLT2448	\$200.87
711-19	NPS-52	\$12.09
711-95	INSTALL	\$100.00

1c Houly Rate : N/a

2 Maximum Order: \$100,000.00

3 Minimum Order: \$100.00

### 4 Geographic Coverage:

Continental United States and the District of Columbia

### 5 Point of Production:

Dover, DE , Mexicali, Mexico and Taiwan

### 6 Prices shown are Government Net

Dicscount is already deducted

### 7 Quantity Discounts:

NA

### 8 Prompt payment discount:

Net 30

### 9a Government Credit Card Accepted:

Below micropurchase threshold

### 9b Government Credit Card Accepted:

Above micropurchase threshold

### 10 Foreign Items:

Mexico and Taiwan

### 11a Delivery Time:

30 to 45 day

### 11b Quick Ship:

15- 29 days for 50 items or less

### 11c Overnight and 2-Day Delivery Available:

Yes. Contract contractor for rates.

### 11d Urgent Requirements:

Contact contractor

### 12 FOB Point:

DE, Mexico, CA, TN and Clifton NJ  
Origin Pre-Paid and Add

**13a Ordering Address:**

ATD-AMERICAN CO./Hirsh  
Attn: Government Sales  
135 Greenwood Avenue  
Wyncote, PA 19095  
Telephone 888-283-2378 or 215-576-1003  
Fax 800-283-7363  
Email [govsales@atd.com](mailto:govsales@atd.com)

**13b Ordering procedures for supplies and services;**

The ordering procedures, information or Blanket Purchase Agreements (BPA's), and a BPA can be Found at the GSA/FSS Schedule homepage ([fss.gsa.gov/schedules](http://fss.gsa.gov/schedules))

**14 Payment Address:**

ATD-AMERICAN CO.  
P.O. Box 8500S-2895  
Philadelphia, PA 19178-0001

**15 Warranty:**

Standard Commercial Warranty

**16 Export Packaging Charges:**

N/A

**17 Terms and Conditions of Government**

**Commercial Credit Card:**

Accepted for all purchases

**18 Terms and Conditions for Rental, Maintenance and Repair:**

N/A

**19 Terms and Conditions of Installation:**

Contact Contractor

**20a Terms and Conditions of repair parts**

**indicating date of parts price lists and any discounts from list price:**

N/A

**20b Terms and Conditions for any other services:**

N/A

**21 List of Distribution Points:**

N/A

**22 List of Participating Dealers:**

Contact Contractor

**23 Preventative Maintenance:**

N/A

**24a Environmental Attributes, e.g., recycled content, energy efficiency, and/or reduced pollutants:**

N/A

**24b Section 508 Compliance:** N/A

**25 Date Universal Number System**

**(DUNS) number:**

#001992338

**26 Central Contractor Registration**

**(CCR) Number:**

Cage Code 5A439